

**POWER REQUIREMENTS**  
58W @ 24VDC  
One Class 2 LED driver required.  
DO NOT CONNECT DIRECTLY TO LINE VOLTAGE!

**MOUNTING**  
Fixture can mount directly to a hollow wall (toggle bolts included). Two mounting points 48" apart on center.  
Adapter plate included for optional j-box mounting. Fixture weighs less than 10 pounds.

**TECHNICAL SUPPORT**  
Need help styling the rope?  
Scan the QR code to view the fixture in 3D!  
Call us at the number below if you need help.



## Shield Sconce 11.3 - Direct-To-Wall Mounting



**WARNING: 24VDC ONLY**

*Do not wire directly to line voltage or the fixture will be permanently damaged.*

3/4" DIAMETER  
HOLE

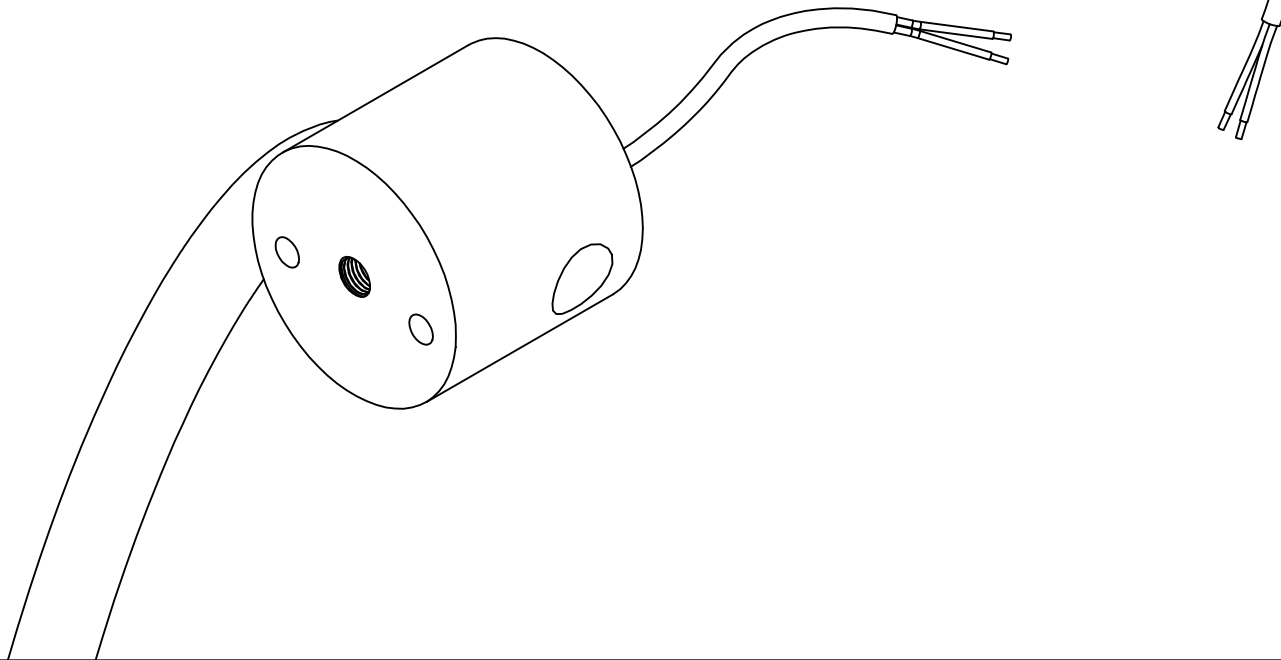

## Shield Sconce 11.3 - Direct-To-Wall Mounting



**WARNING: 24VDC ONLY**

*Do not wire directly to line voltage or the fixture will be permanently damaged.*

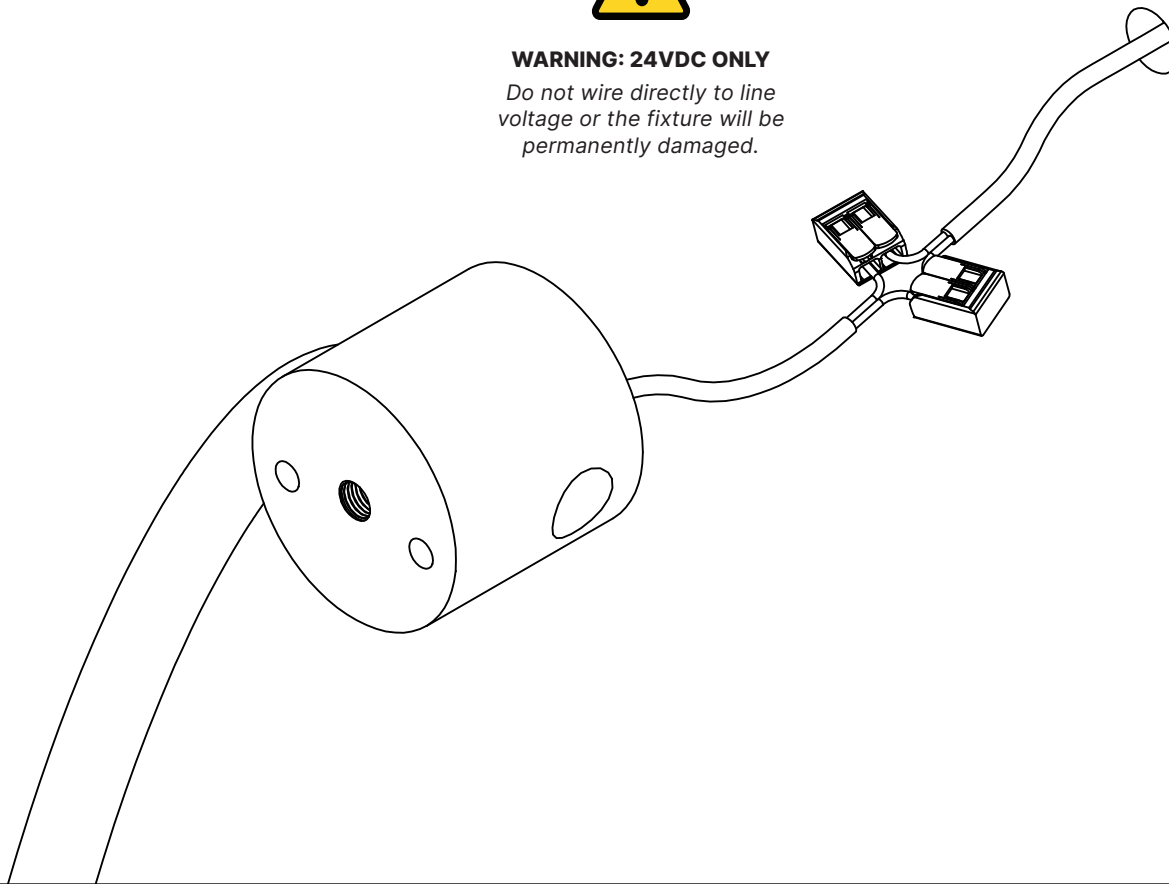

## Shield Sconce 11.3 - Direct-To-Wall Mounting

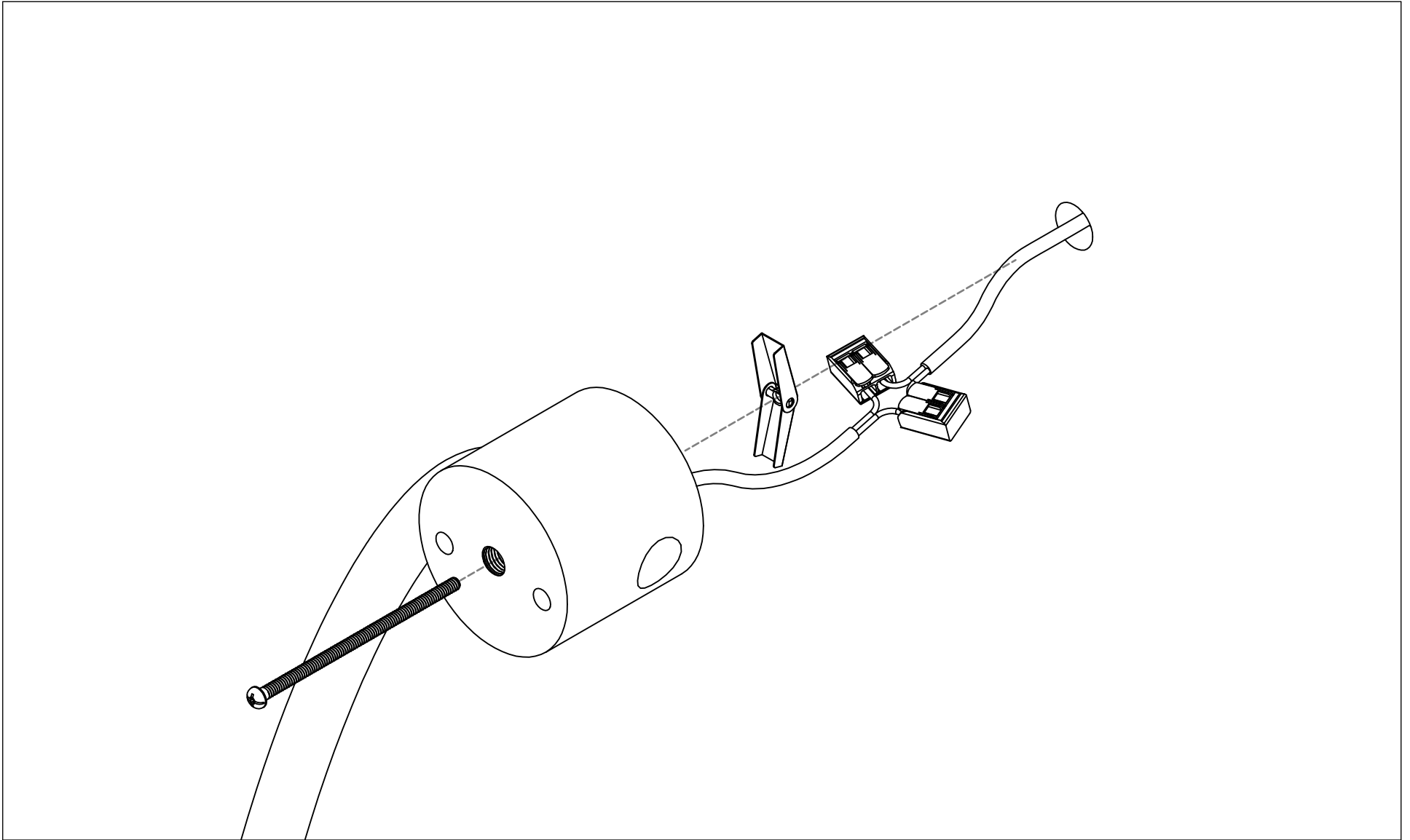

## Shield Sconce 11.3 - Direct-To-Wall Mounting

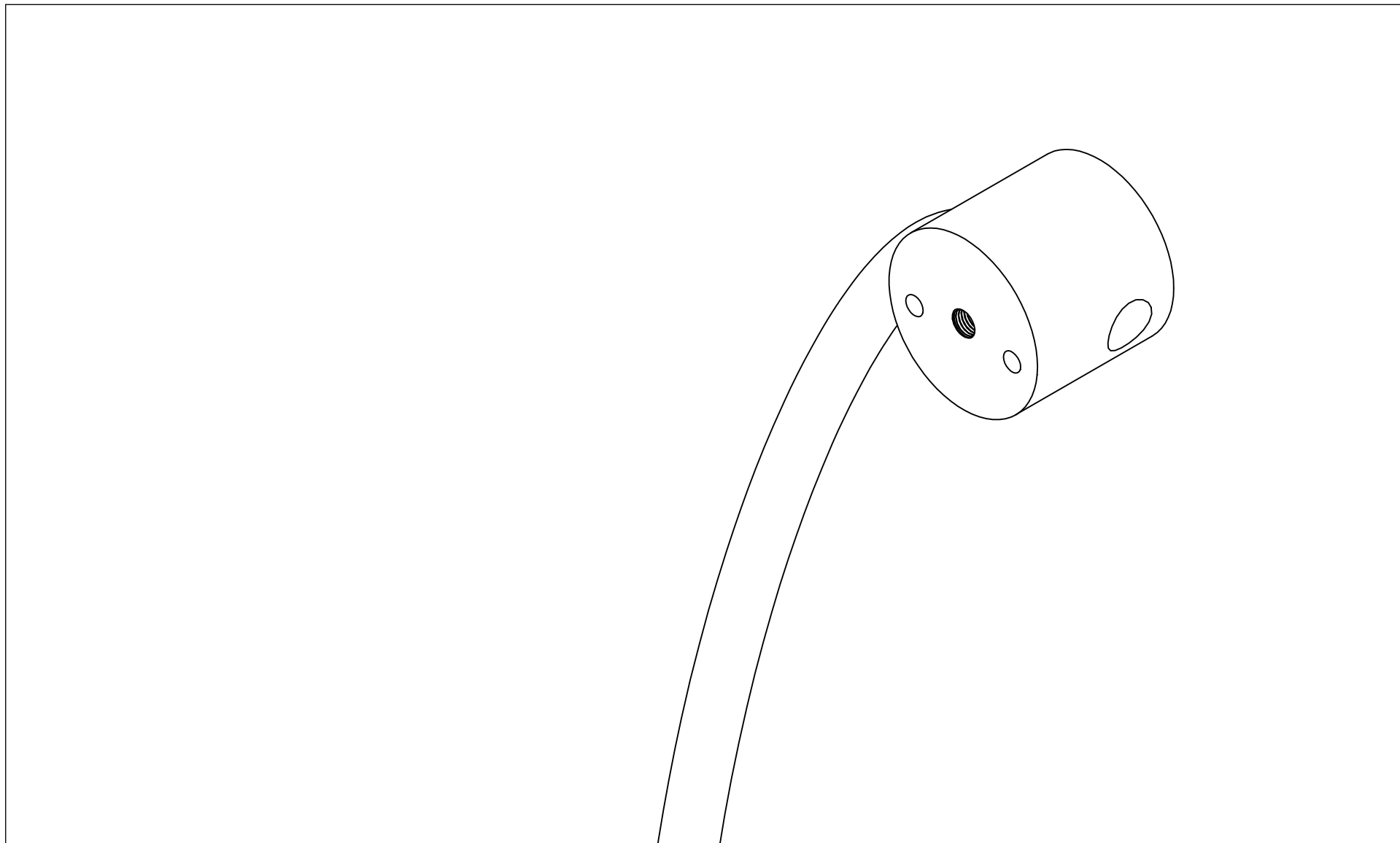

## Shield Sconce 11.3 - Direct-To-Wall Mounting

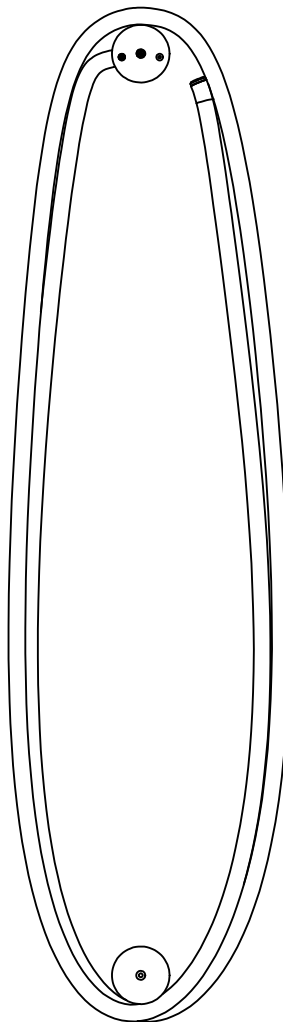

## Shield Sconce 11.3 - Direct-To-Wall Mounting

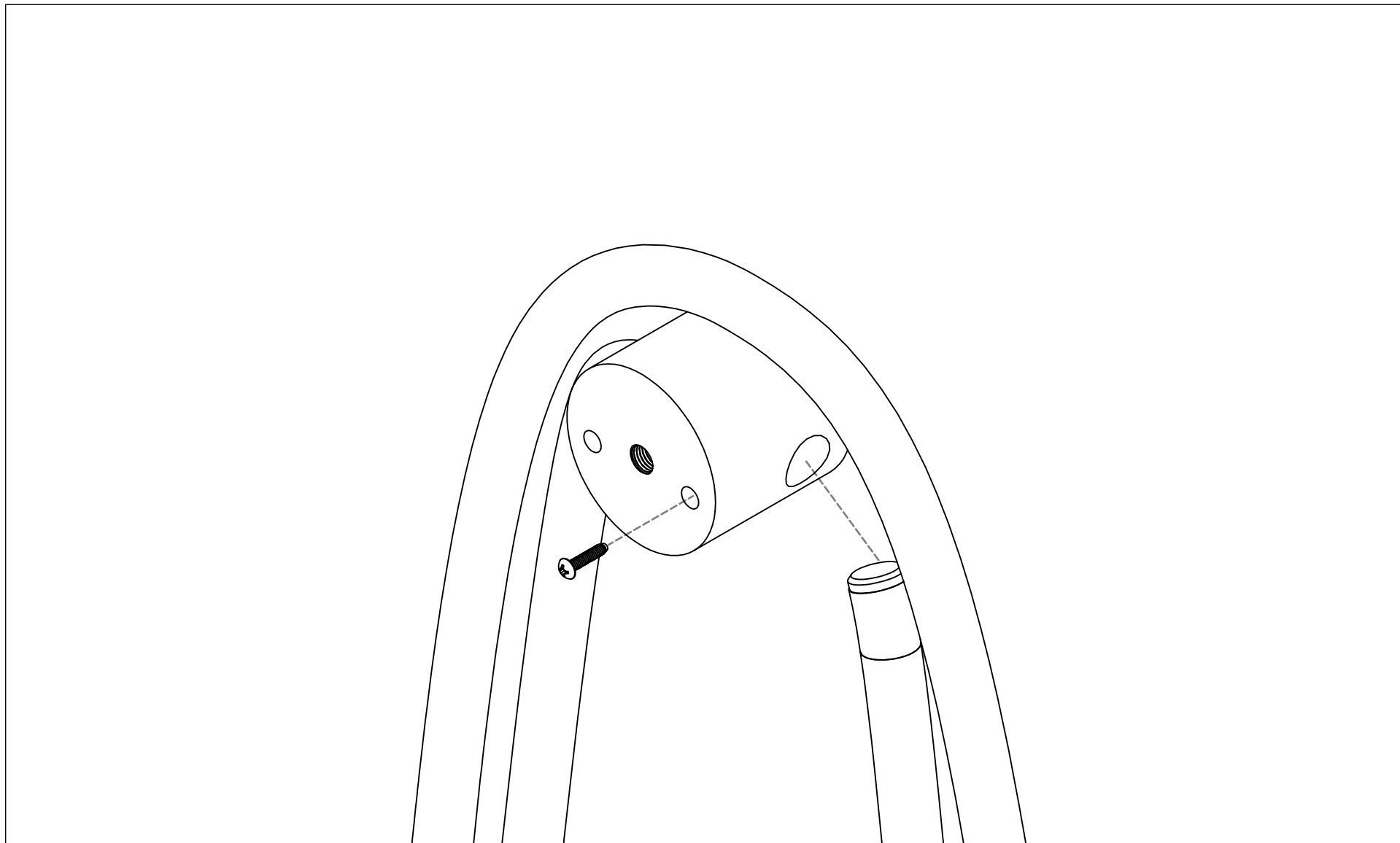

## Shield Sconce 11.3 - Direct-To-Wall Mounting

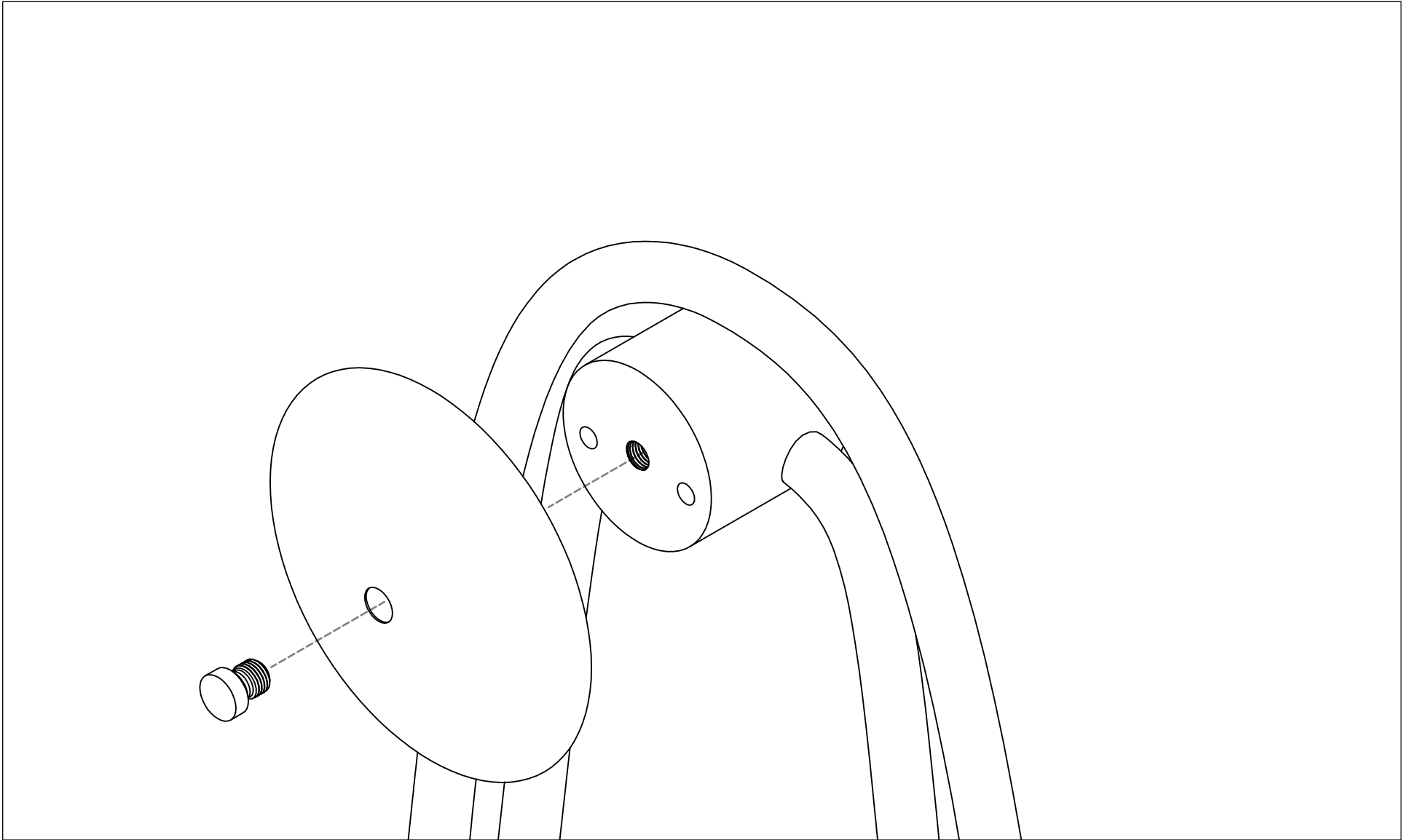



## Shield Sconce 11.3 - Junction Box Mounting

48"  
CANOPY SPACING  
  
(Top canopy is  
powered, bottom is  
for mounting only)

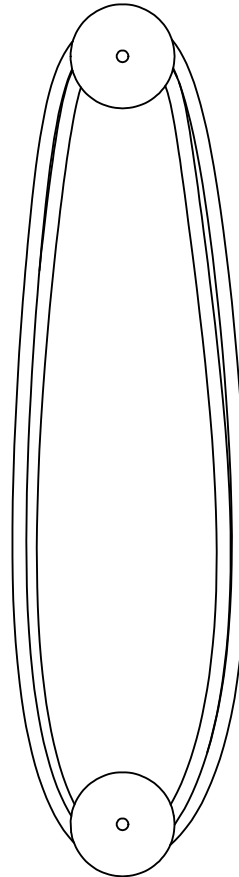

**THIS IS A LOW VOLTAGE (24VDC) FIXTURE.**

*Do not wire this fixture directly to line voltage! The fixture requires a 24VDC Class 2 Transformer (LED Driver). The 24VDC driver must be mounted per the included manufacturer's instructions. Also, please ensure that the wiring system complies with NEC requirements.*



**PLEASE HANDLE WITH CARE.**

*All protective packaging should be left on the fixture (especially the clear protective sleeve that covers the rope and frame) until it is completely installed and all nearby construction is complete. Failure to do so may result in the fixture being permanently damaged.*

## Shield Sconce 11.3 - Junction Box Mounting



**WARNING: 24VDC ONLY**

*Do not wire directly to line voltage or the fixture will be permanently damaged.*

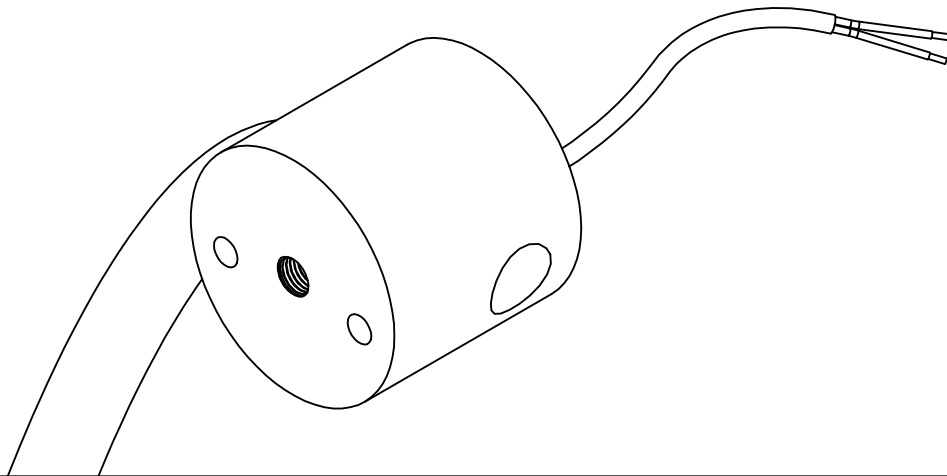
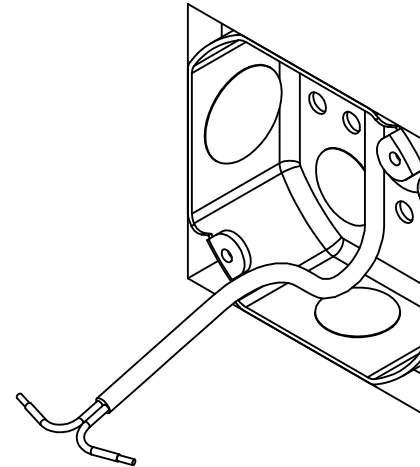

## Shield Sconce 11.3 - Junction Box Mounting

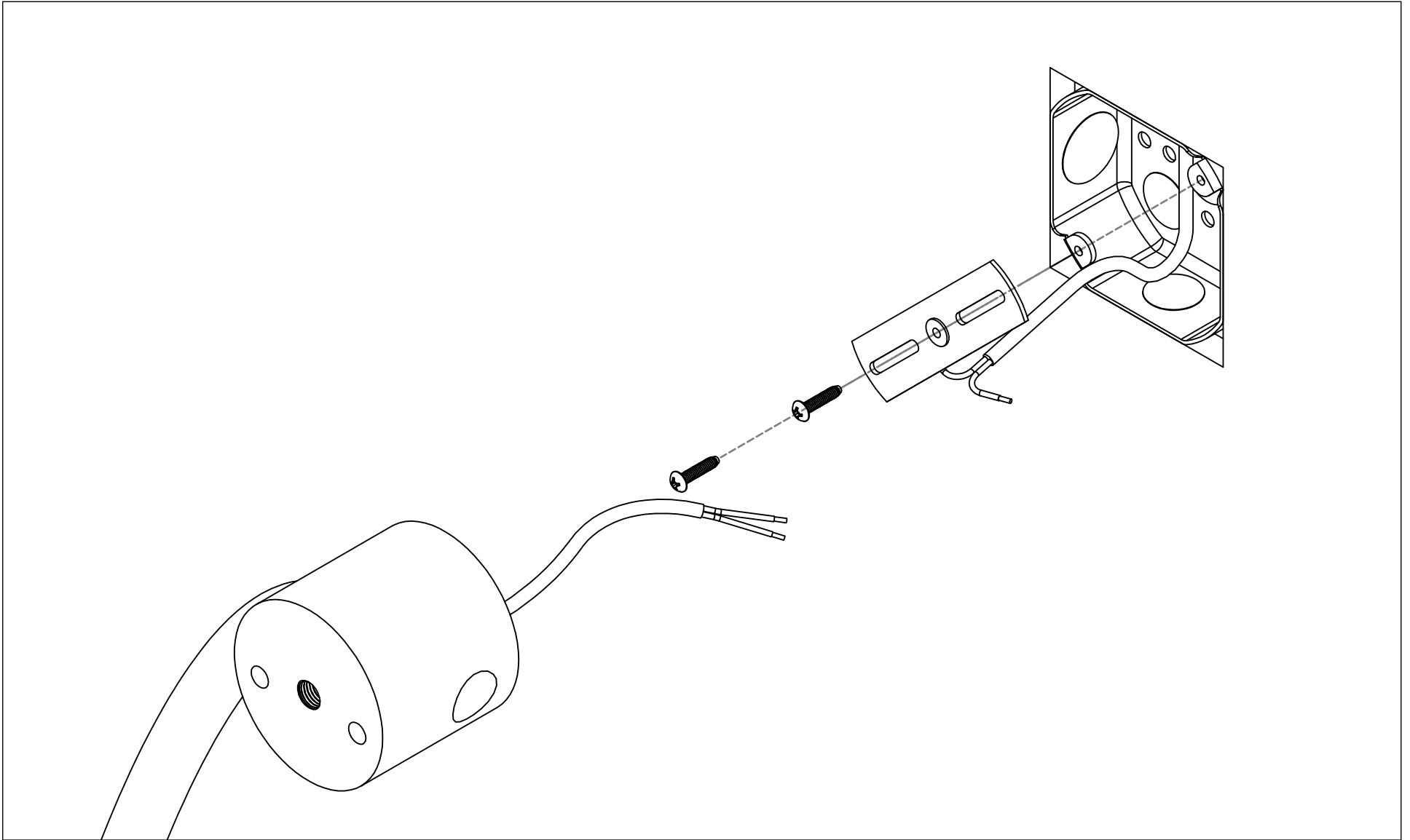

## Shield Sconce 11.3 - Junction Box Mounting



**WARNING: 24VDC ONLY**

*Do not wire directly to line  
voltage or the fixture will be  
permanently damaged.*

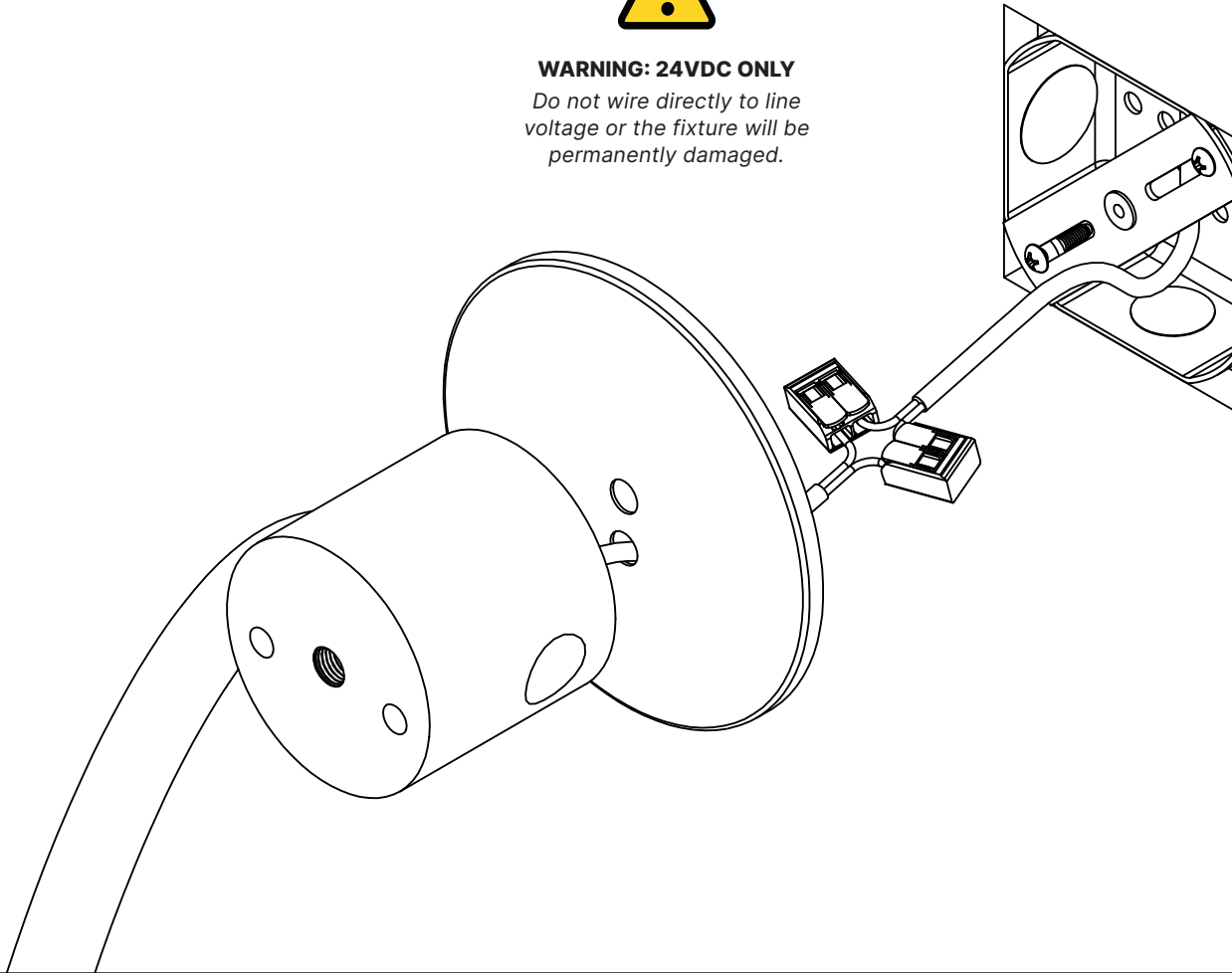

## Shield Sconce 11.3 - Junction Box Mounting

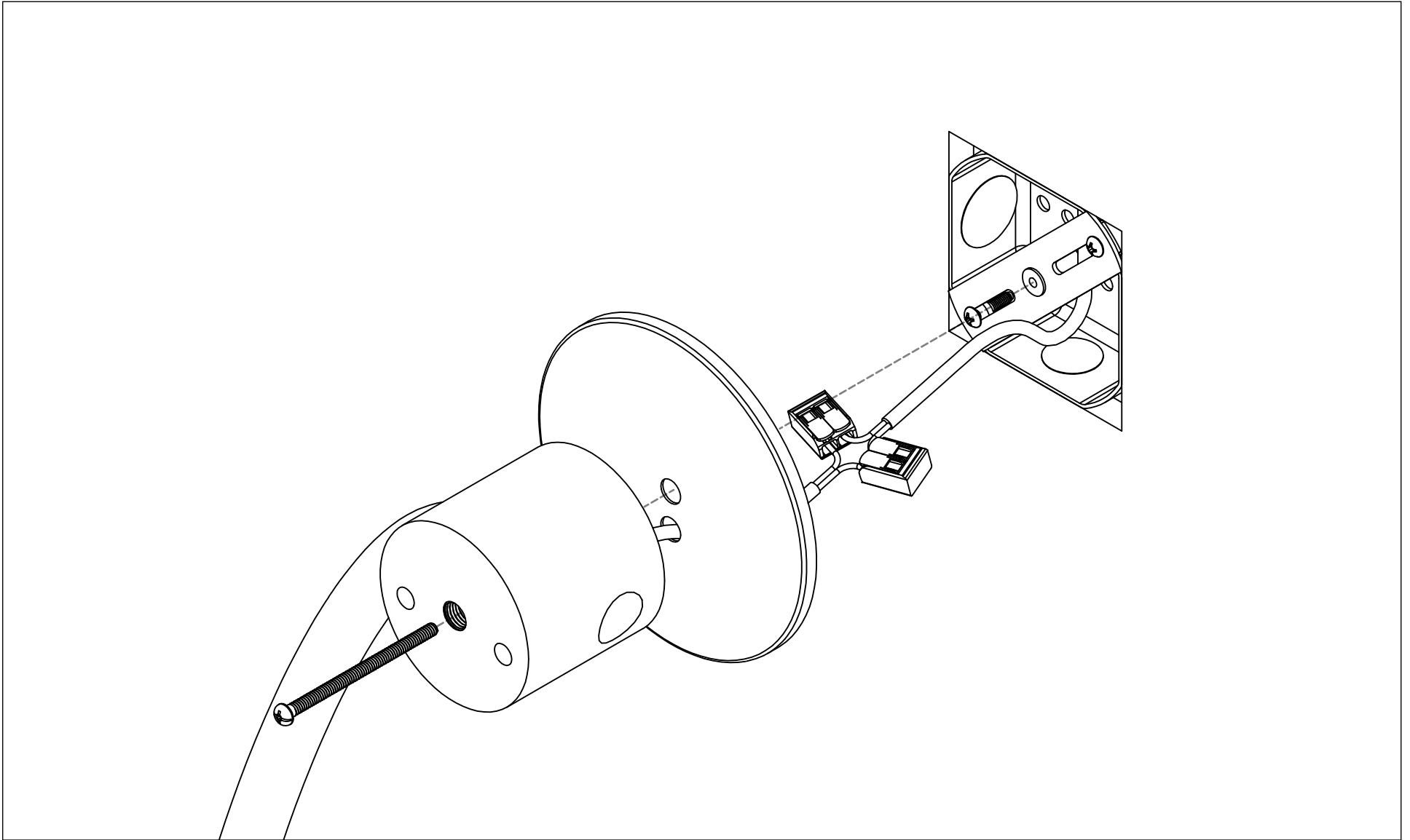

## Shield Sconce 11.3 - Junction Box Mounting

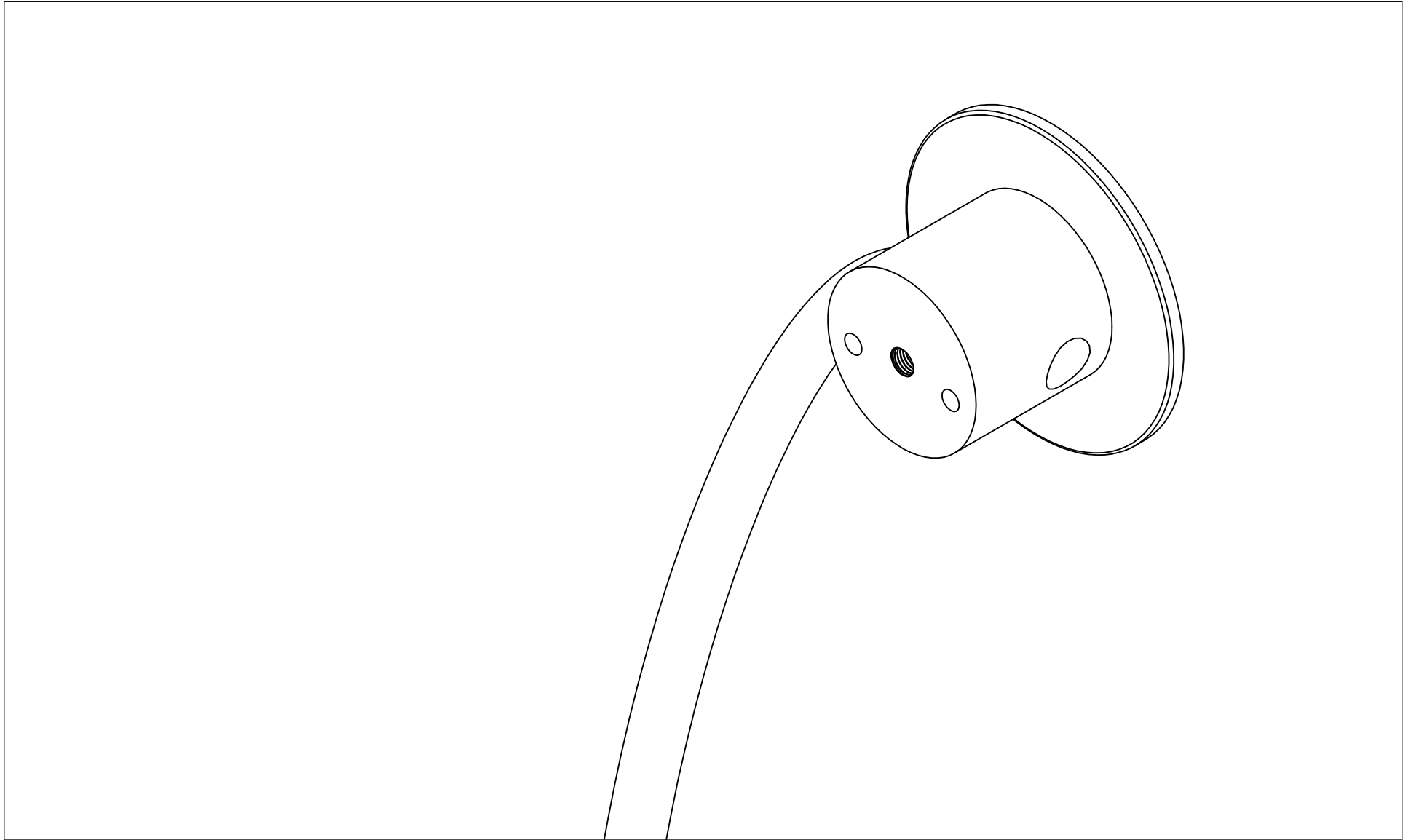

Shield Sconce 11.3 - Junction Box Mounting

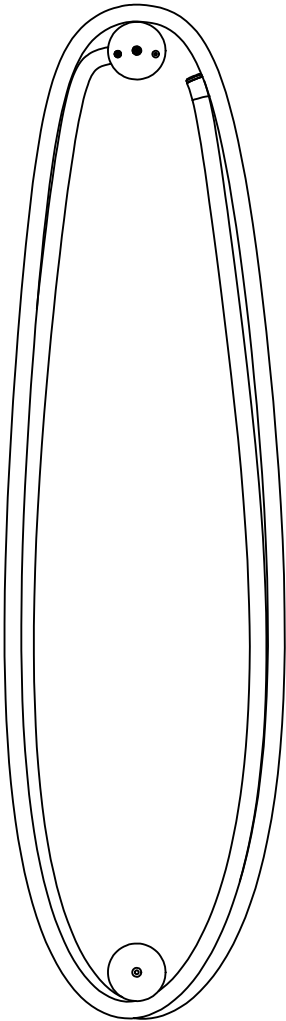

## Shield Sconce 11.3 - Junction Box Mounting

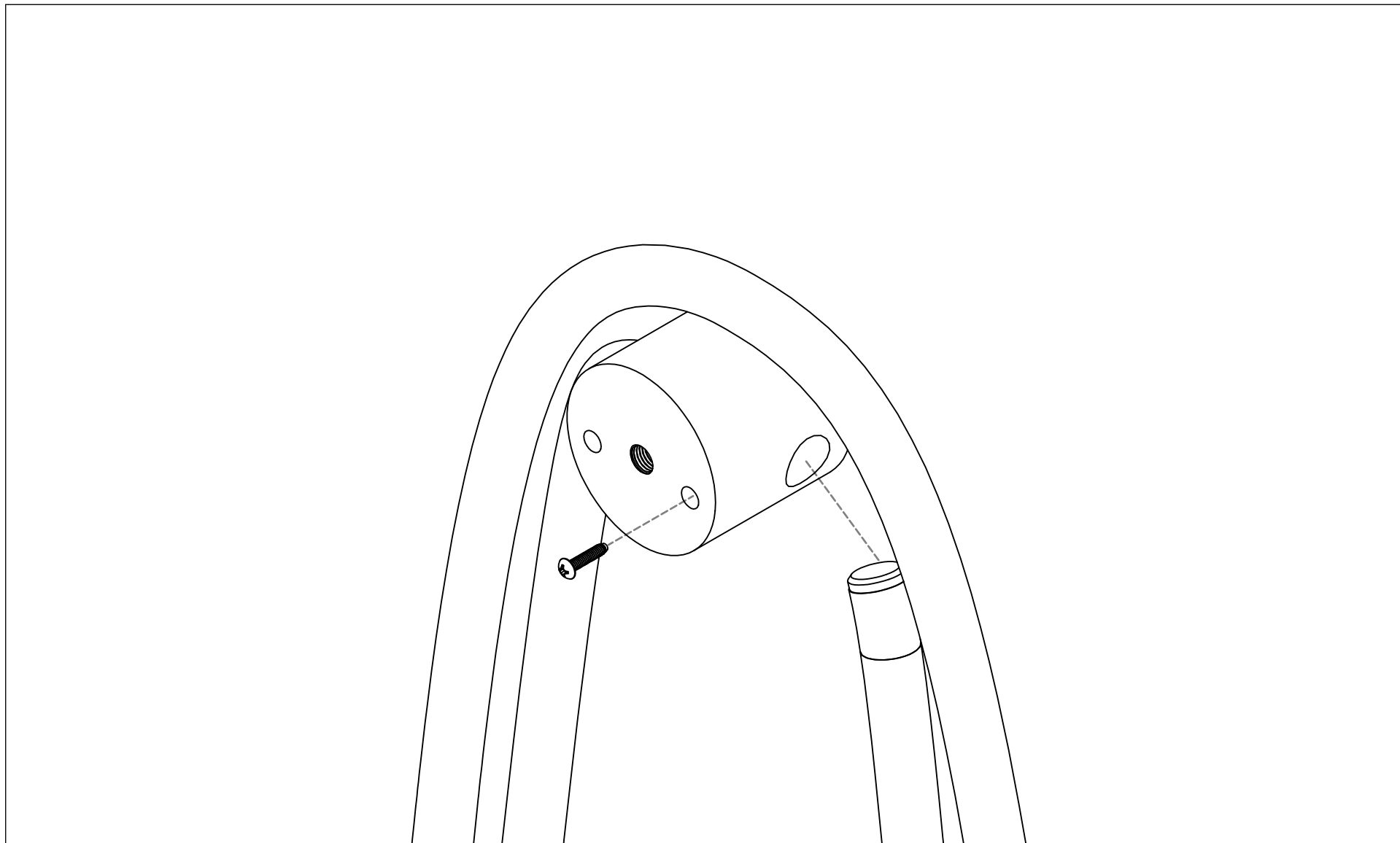



## Shield Sconce 11.3 - Junction Box Mounting

