

POWER REQUIREMENTS

43W @ 24VDC
One Class 2 LED driver required.
DO NOT CONNECT DIRECTLY TO LINE VOLTAGE!

MOUNTING

Single junction box centered on the fixture. Two standalone aircraft cables spaced 48" apart. Fixture weighs less than 20 pounds.

TECHNICAL SUPPORT

Need help styling the rope?
Scan the QR code to view the fixture in 3D!
Call us at the number below if you need help.



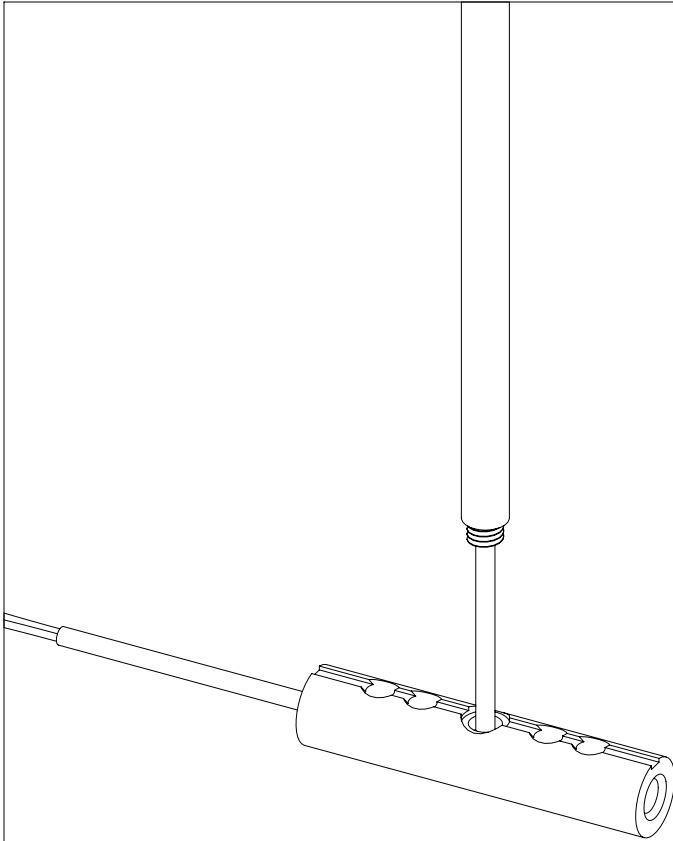

THIS IS A LOW VOLTAGE (24VDC) FIXTURE.

Do not wire this fixture directly to line voltage! The fixture requires a 24VDC Class 2 Transformer (LED Driver). The 24VDC driver must be mounted per the included manufacturer's instructions. Also, please ensure that the wiring system complies with NEC requirements.



PLEASE HANDLE WITH CARE.

All protective packaging should be left on the fixture (especially the clear protective sleeve that covers the rope and frame) until it is completely installed and all nearby construction is complete. Failure to do so may result in the fixture being permanently damaged.

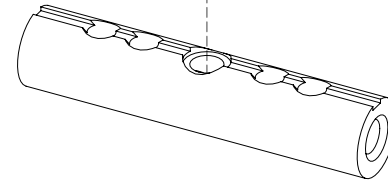

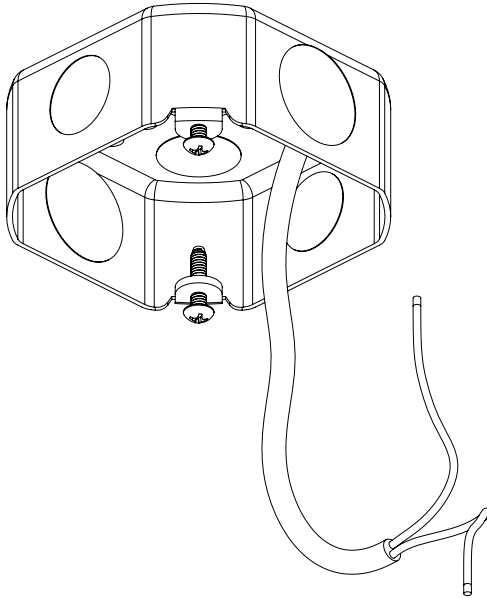

WARNING: 24VDC ONLY
*Do not wire directly to line
voltage or the fixture will be
permanently damaged.*

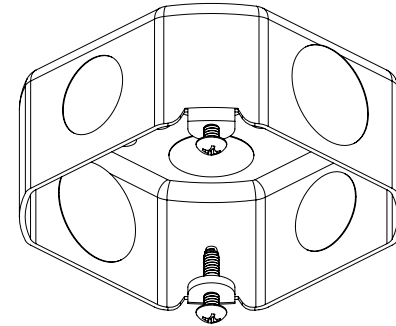

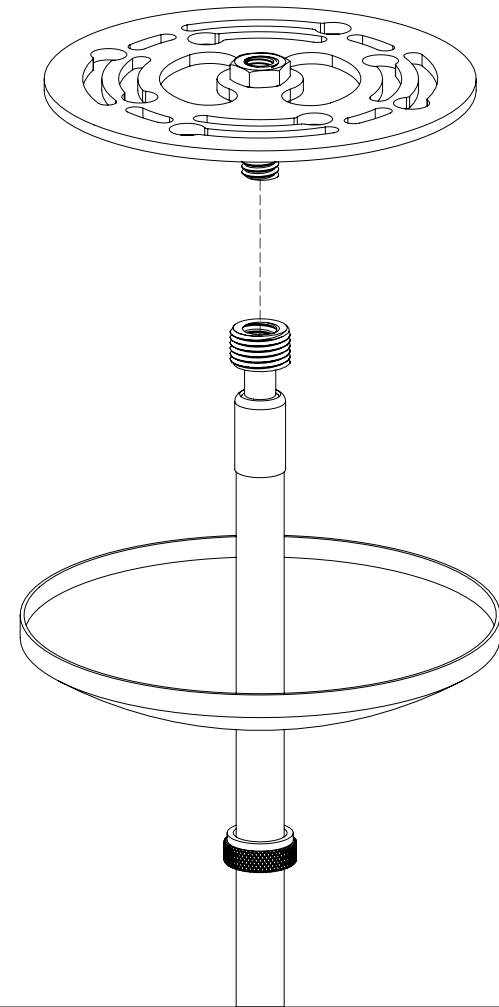
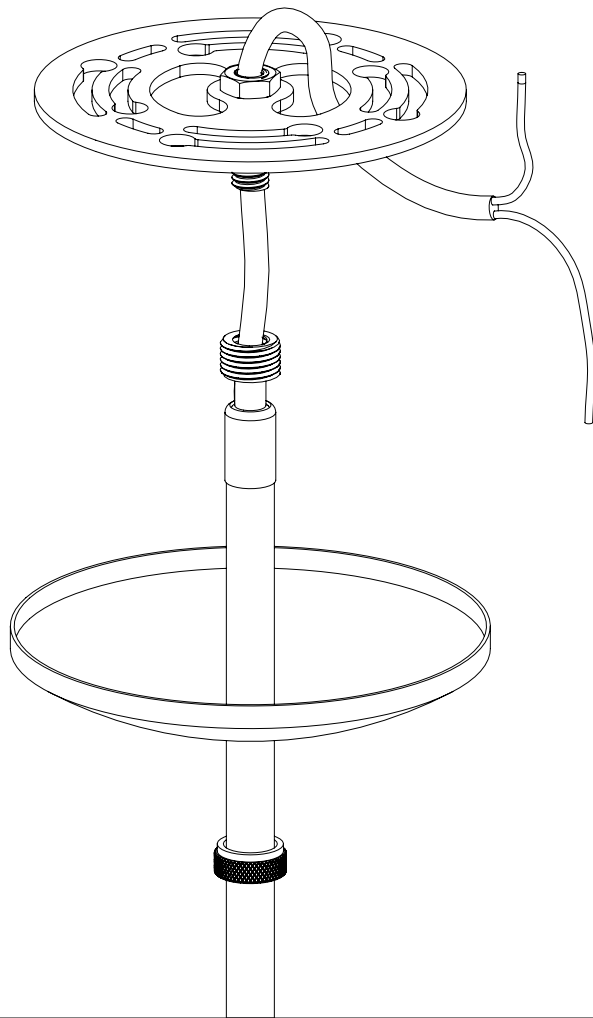

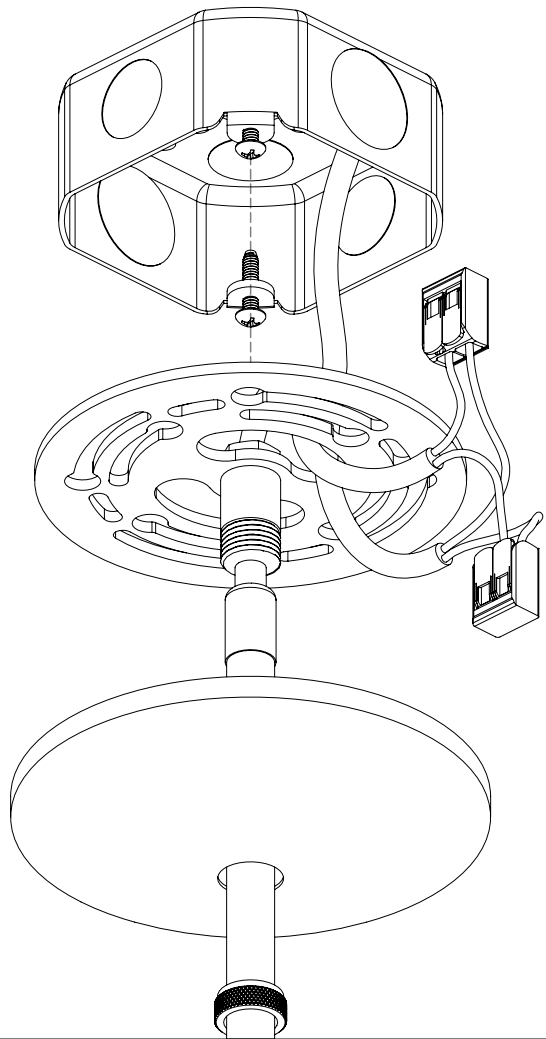

WARNING: 24VDC ONLY
*Do not wire directly to line
voltage or the fixture will be
permanently damaged.*

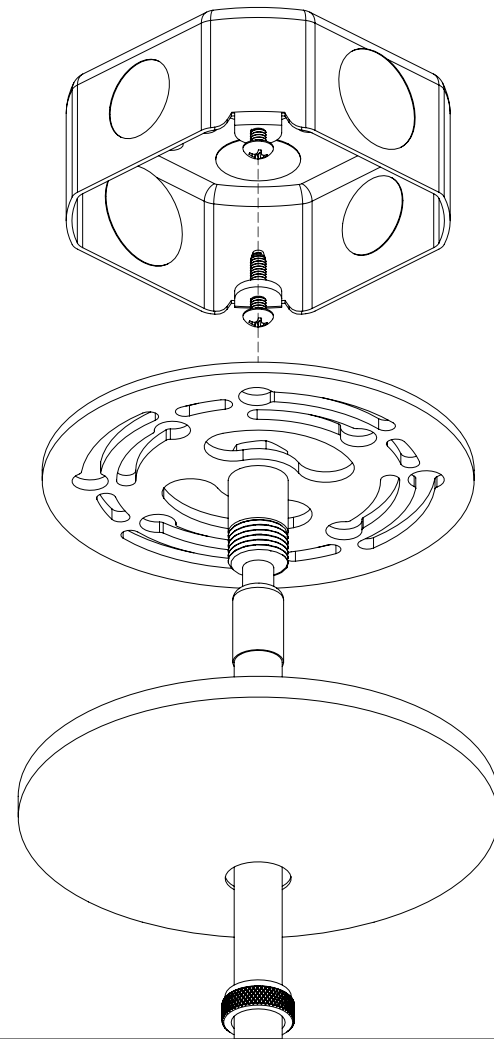

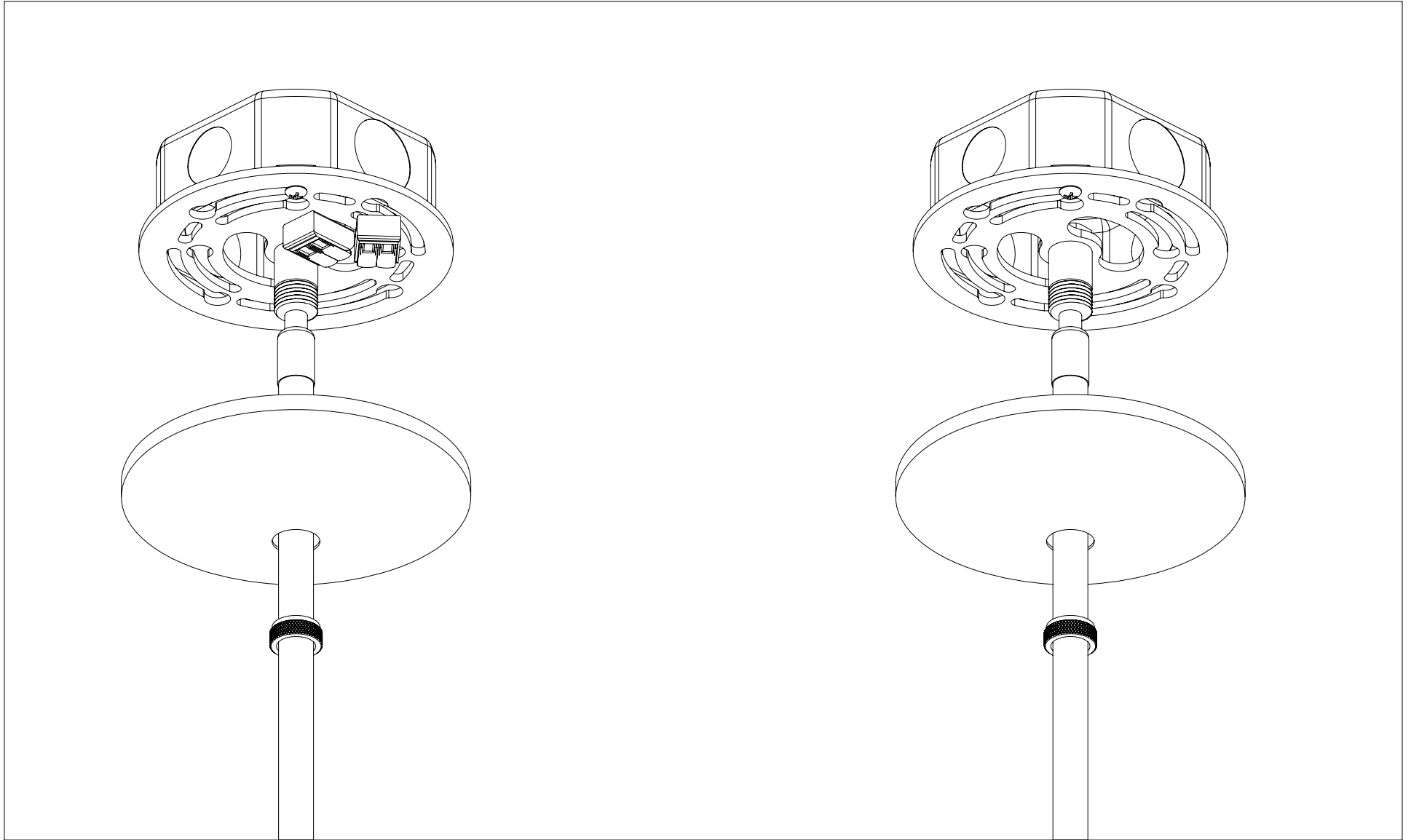

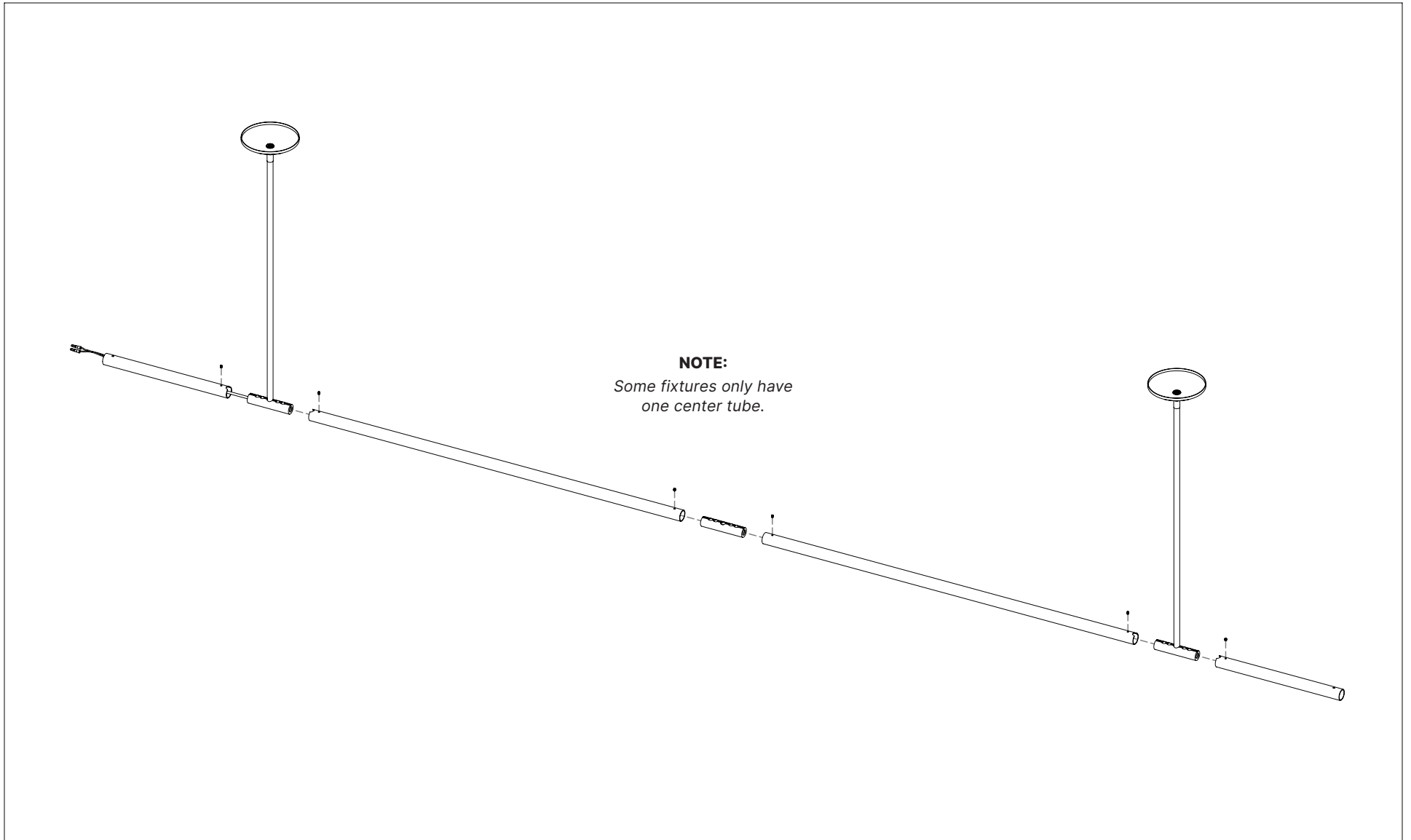

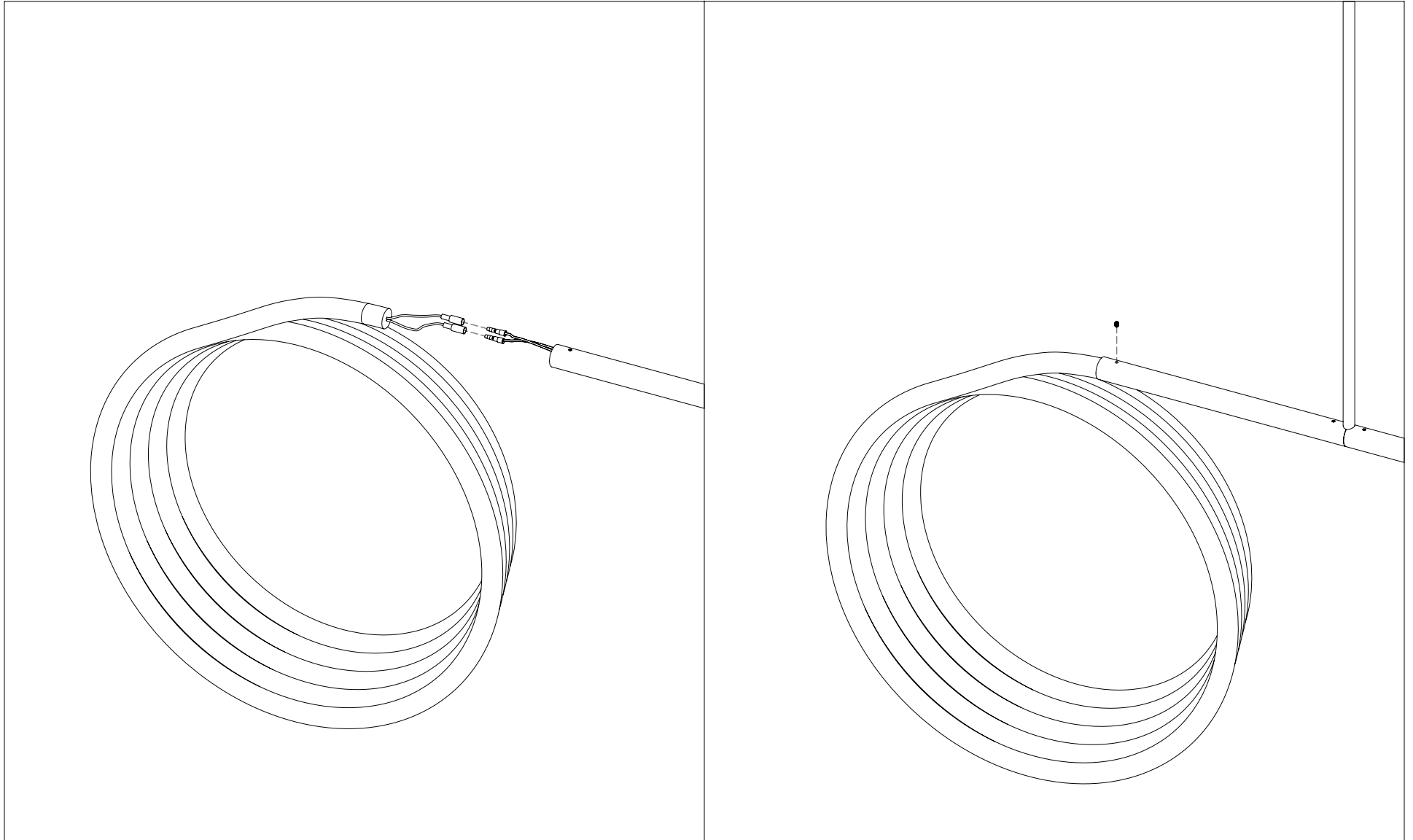

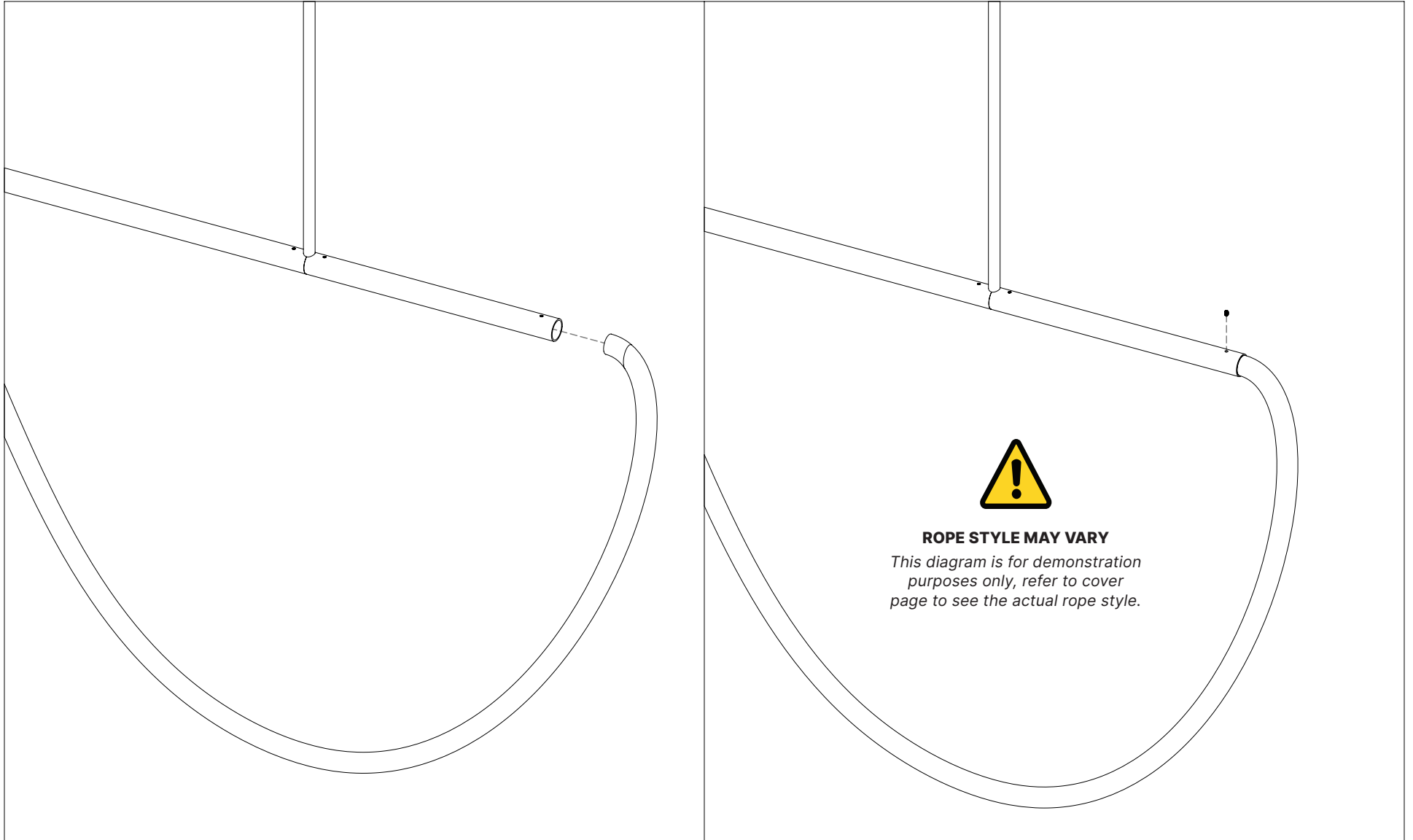



<div><div>Carefully Cut Rod Sleeve To Desired Length</div></div>	<p>If the vertical rods need to be shortened, first cut the outer sleeve to the desired length. Make sure to cut very carefully so that you do not damage the finish.</p> <p>For helpful videos, visit: lukelampco.com/videoresources</p>
<div><div>Cut Threaded Rod 1/2 inch Longer Than Rod Sleeve</div></div>	<p>Next, cut the threaded rod 1/2 inch longer than the rod sleeve.</p>
<div><div>Threaded Rod Protrudes 1/4 inch On Both Ends</div></div>	<p>Finally, insert the threaded rod into the rod sleeve. The threaded rod should protrude 1/4 inch at both ends. Reattach the hang-straight joint and proceed with installation.</p>

